

FOR LEASE: 29,000 SQUARE FEET  
9033 PREMIER ROW, DALLAS, TX 75247

INDUSTRIAL REAL ESTATE BROKERAGE

WWW.MERCER-COMPANY.COM

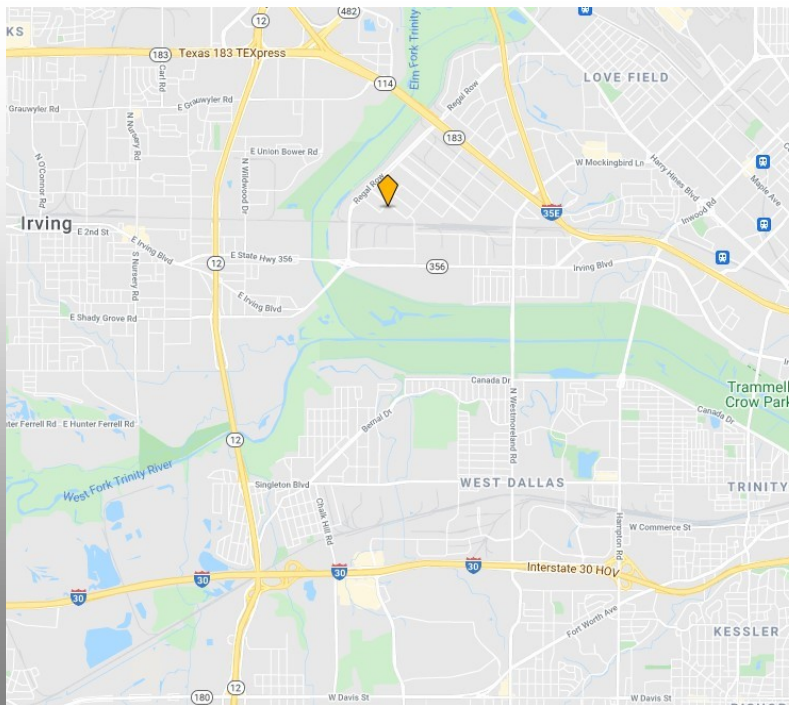
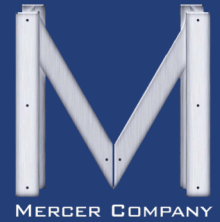

## DETAILS

- ◆ TOTAL SF: 29,000
- ◆ OFFICE SF: 3,000
- ◆ CLEAR HEIGHT: 15'
- ◆ DOCK DOORS: 3
- ◆ GRADE LEVEL DOORS: 1 RAMP
- ◆ POWER: 3P/1600AMPS+
- ◆ SPRINKLERED
- ◆ PARKING: 14 SURFACE SPACES
- ◆ FENCED OUTSIDE STORAGE

CORBY HODGKISS  
CELL 469.360.3918  
CHODGKISS@MERCER-COMPANY.COM

TURNER PETERSEN  
CELL 214.906.4220  
TPETERSEN@MERCER-COMPANY.COM

FOR LEASE: 29,000 SQUARE FEET  
9033 PREMIER ROW, DALLAS, TX 75247

INDUSTRIAL REAL ESTATE BROKERAGE

WWW.MERCER-COMPANY.COM

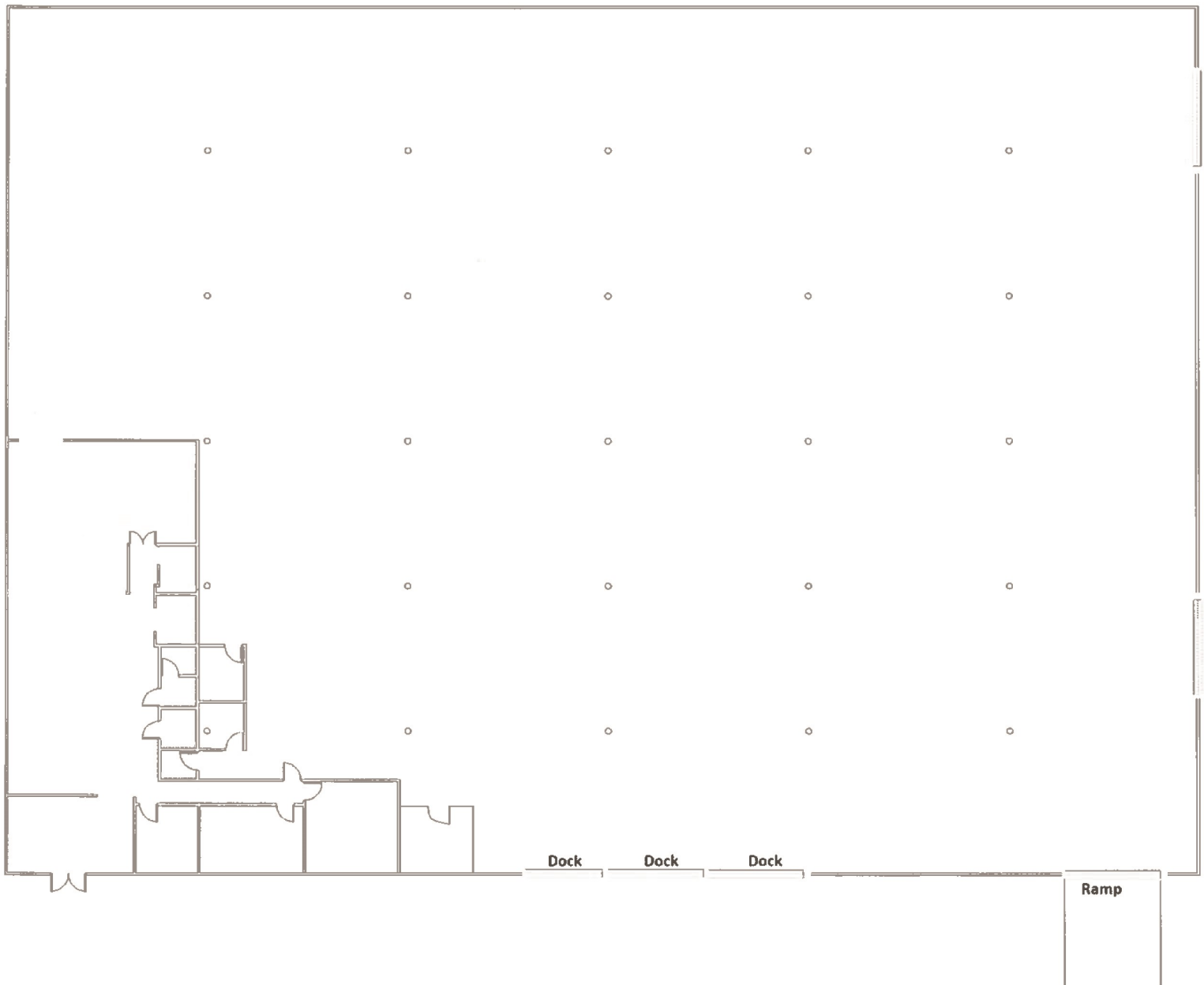

The information contained herein has been given to us by the owner of the property or other sources we deem reliable. We have no reason to doubt its accuracy, but we do not guarantee it. All information should be verified before purchase or lease.